

**M54 to M6 Link Road**  
**TR010054**  
**Volume 2**

**2.7 Streets, Rights of Way and Access Plans**

Regulation 5(2)(k)

Planning Act 2008

Infrastructure Planning (Applications: Prescribed  
Forms and Procedure) Regulations 2009

February 2021

Infrastructure Planning

Planning Act 2008

**The Infrastructure Planning  
(Applications: Prescribed Forms and  
Procedure) Regulations 2009**

**M54 to M6 Link Road  
Development Consent Order 202[ ]**

---

**Streets, Rights of Way and Access Plans**

---

<b>Regulation Number</b>	Regulation 5(2)(k)
<b>Planning Inspectorate Scheme Reference</b>	TR010054
<b>Application Document Reference</b>	2.7
<b>Author</b>	M54 to M6 Link Road Project Team and Highways England

<b>Version</b>	<b>Date</b>	<b>Status of Version</b>
P04	February 2021	Issued to the ExA at Deadline 6

## Schedule of Plans included in this Application Document

Drawing Number	Drawing Title	Revision
HE514465-ACM-DCO-M54_SW_PR_Z-DR-CH-1400	STREETS, RIGHTS OF WAY AND ACCESS PLANS REGULATION 5(2)(K) KEY SHEET	P06
HE514465-ACM-DCO-Z1_SW_PR_Z-DR-CH-1401	STREETS, RIGHTS OF WAY AND ACCESS PLANS REGULATION 5(2)(K) SHEET 1 OF 10	P04
HE514465-ACM-DCO-Z1_SW_PR_Z-DR-CH-1402	STREETS, RIGHTS OF WAY AND ACCESS PLANS REGULATION 5(2)(K) SHEET 2 OF 10	P02
HE514465-ACM-DCO-Z1_SW_PR_Z-DR-CH-1403	STREETS, RIGHTS OF WAY AND ACCESS PLANS REGULATION 5(2)(K) SHEET 3 OF 10	P03
HE514465-ACM-DCO-Z1_SW_PR_Z-DR-CH-1404	STREETS, RIGHTS OF WAY AND ACCESS PLANS REGULATION 5(2)(K) SHEET 4 OF 10	P05
HE514465-ACM-DCO-Z2_SW_PR_Z-DR-CH-1405	STREETS, RIGHTS OF WAY AND ACCESS PLANS REGULATION 5(2)(K) SHEET 5 OF 10	P06
HE514465-ACM-DCO-Z3_SW_PR_Z-DR-CH-1406	STREETS, RIGHTS OF WAY AND ACCESS PLANS REGULATION 5(2)(K) SHEET 6 OF 10	P04
HE514465-ACM-DCO-Z3_SW_PR_Z-DR-CH-1407	STREETS, RIGHTS OF WAY AND ACCESS PLANS REGULATION 5(2)(K) SHEET 7 OF 10	P02
HE514465-ACM-DCO-Z3_SW_PR_Z-DR-CH-1408	STREETS, RIGHTS OF WAY AND ACCESS PLANS REGULATION 5(2)(K) SHEET 8 OF 10	P02
HE514465-ACM-DCO-Z3_SW_PR_Z-DR-CH-1409	STREETS, RIGHTS OF WAY AND ACCESS PLANS REGULATION 5(2)(K) SHEET 9 OF 10	P02
HE514465-ACM-DCO-Z3_SW_PR_Z-DR-CH-1410	STREETS, RIGHTS OF WAY AND ACCESS PLANS REGULATION 5(2)(K) SHEET 10 OF 10	P02



- NOTES**
1. THIS DRAWING IS TO BE READ IN CONJUNCTION WITH ALL OTHER RELEVANT DOCUMENTATION.
  2. DO NOT SCALE FROM THIS DRAWING, USE ONLY PRINTED DIMENSIONS.
  3. ALL DIMENSIONS IN MILLIMETRES, ALL CHAINAGES, LEVELS AND COORDINATES ARE IN METRES UNLESS DEFINED OTHERWISE.
  4. THIS DRAWING IS TO BE READ IN CONJUNCTION WITH THE PROJECT HEALTH & SAFETY FILE FOR ANY IDENTIFIED POTENTIAL RISKS.
  5. THE WORKS ARE SHOWN ILLUSTRATIVELY ONLY AND ARE SUBJECT TO CHANGE THROUGH DETAILED DESIGN IN ACCORDANCE WITH THE TERMS OF THE DEVELOPMENT CONSENT ORDER.
  6. THIS PLAN WAS AMENDED IN MAY 2020 TO REMOVE A SMALL AREA OF THE ORDER LIMITS WITHIN THE HIGHWAY BOUNDARY OF THE M54 PREVIOUSLY INCLUDED FOR THE REPLACEMENT OF A ROAD SIGN. THE REPLACEMENT OF THIS SIGN IS NO LONGER REQUIRED. THIS CHANGE MEANS THAT SHROPSHIRE COUNTY COUNCIL IS NO LONGER A HOST AUTHORITY FOR THE SCHEME.

- KEY**
- LIMITS OF LAND TO BE ACQUIRED OR USED PERMANENTLY OR TEMPORARILY (THE ORDER LIMITS)
  - LAND NOT INCLUDED WITHIN THE ORDER LIMITS

Revision	By	Check	Date	Suffix
First Issue	MW	RR	06/12/19	P01
Updated following Consultee comments	MW	RR	16/01/20	P02
Minor amendments	MW	RR	21/01/20	P03
Sheet 1 Inset 'A' removed	MW	RR	12/03/20	P04
Note 6 added	MW	RR	11/05/20	P05
Updated to reflect Oct 2020 scheme changes	MW	RR	21/09/20	P06

**DCO APPLICATION**

Client  
Highways England  
Floor 5  
38 Colmore Circus  
Birmingham  
B4 6BN

Development Consent Order Number  
**TR010054**

Project Title  
**M54 to M6 Link Road**

Development Consent Order Drawing Number  
**TR010054/APP/2.7**

Drawing Title  
**STREETS, RIGHTS OF WAY AND ACCESS PLANS REGULATION 5(2)(K) KEY SHEET**

Designed	Drawn	Checked	Approved	Date
MW	MW	AM	RR	21/09/20

Internal Project No.  
60536736

Scale @ A1  
1:20000H/1:20000V

Suitability  
S8

Zone  
Development Consent Order

THIS DOCUMENT HAS BEEN PREPARED PURSUANT TO AND SUBJECT TO THE TERMS OF AECOM'S APPOINTMENT BY ITS CLIENT. AECOM ACCEPTS NO LIABILITY FOR ANY USE OF THIS DOCUMENT OTHER THAN BY ITS ORIGINAL CLIENT OR FOLLOWING AECOM'S EXPRESS AGREEMENT TO SUCH USE, AND ONLY FOR THE PURPOSES FOR WHICH IT WAS PREPARED AND PROVIDED.

Drawing Number	Highways England PIN	Originator	Volume	Rev
HE514465	-ACM	-DCO-		P06
M54_SW_PR_Z		-DR-CH-1400		

Location | Type | Role | Number



**NO PROPOSED WORKS AS PART OF THIS PACKAGE ARE DISPLAYED ON THIS DRAWING**



- NOTES**
1. THIS DRAWING IS TO BE READ IN CONJUNCTION WITH ALL OTHER RELEVANT DOCUMENTATION.
  2. DO NOT SCALE FROM THIS DRAWING, USE ONLY PRINTED DIMENSIONS.
  3. ALL DIMENSIONS IN MILLIMETRES, ALL CHAINAGES, LEVELS AND COORDINATES ARE IN METRES UNLESS DEFINED OTHERWISE.
  4. THIS DRAWING IS TO BE READ IN CONJUNCTION WITH THE PROJECT HEALTH & SAFETY FILE FOR ANY IDENTIFIED POTENTIAL RISKS.
  5. THE WORKS ARE SHOWN ILLUSTRATIVELY ONLY AND ARE SUBJECT TO CHANGE THROUGH DETAILED DESIGN IN ACCORDANCE WITH THE TERMS OF THE DEVELOPMENT CONSENT ORDER.
  6. AREAS OF EXISTING CARRIAGEWAY TO BE REMOVED ARE SHOWN FOR INFORMATION ONLY. THESE AREAS ARE NOT TO BE STOPPED UP AS THEY WILL REMAIN WITHIN THE PUBLIC HIGHWAY BOUNDARY AND IN SOME CASES DIRECTLY REPLACED WITH NEW HIGHWAY ALIGNMENTS.
  7. THIS PLAN WAS AMENDED IN MAY 2020 TO REMOVE A SMALL AREA OF THE ORDER LIMITS WITHIN THE HIGHWAY BOUNDARY OF THE M54 PREVIOUSLY INCLUDED FOR THE REPLACEMENT OF A ROAD SIGN. THE REPLACEMENT OF THIS SIGN IS NO LONGER REQUIRED. THIS CHANGE MEANS THAT SHROPSHIRE COUNTY COUNCIL IS NO LONGER A HOST AUTHORITY FOR THE SCHEME

- KEY**
- LIMITS OF LAND TO BE ACQUIRED OR USED PERMANENTLY OR TEMPORARILY (THE ORDER LIMITS)
  - LAND NOT INCLUDED WITHIN THE ORDER LIMITS
  - EXISTING HIGHWAY TO BE STOPPED UP
  - AREAS OF EXISTING CARRIAGEWAY TO BE REMOVED
  - PROPOSED / IMPROVED PRIVATE MEANS OF ACCESS
  - PROPOSED / IMPROVED MAINTENANCE TRACK
  - EXISTING PRIVATE MEANS OF ACCESS TO BE STOPPED UP
  - EXISTING RIGHT OF WAY (BRIDLEWAY)
  - EXISTING RIGHT OF WAY (FOOTPATH)
  - EXISTING RIGHT OF WAY TO BE REMOVED
  - PROPOSED RIGHT OF WAY (BRIDLEWAY)
  - PROPOSED RIGHT OF WAY (FOOTPATH)
  - PROPOSED FOOTWAY
  - PROPOSED SHARED FOOTWAY / CYCLEWAY
  - PRIVATE MEANS OF ACCESS / RIGHT OF WAY TO BE IMPROVED, CREATED OR STOPPED UP DETAILED IN SCHEDULE 4
  - START / END POINT OF AREA OF EXISTING ROAD TO BE CREATED OR STOPPED UP DETAILED IN SCHEDULE 4
  - PROPOSED STRUCTURE

Revision Details	By	Check	Date	Suffix
First Issue	MW	RR	06/12/19	P01
Updated following Consultee comments	MW	RR	16/01/20	P02
Sheet 1 Inset 'A' removed.	MW	RR	12/03/20	P03
Note 7 added.	MW	RR	11/05/20	P04

**Purpose of issue**  
DCO APPLICATION

**Client**  
Highways England  
Floor 5  
Two Colmore Square  
38 Colmore Circus  
Birmingham  
B4 6BN

**Development Consent Order Number**  
TR010054

**Project Title**  
M54 to M6 Link Road



**Development Consent Order Drawing Number**  
TR010054/APP/2.7

**Drawing Title**  
STREETS, RIGHTS OF WAY AND ACCESS PLANS  
REGULATION 5(2)(K)  
SHEET 1 OF 10

Designed	Drawn	Checked	Approved	Date
MW	AM	RR	RR	11/05/20

Internal Project No. 60536736  
Scale @ A1 1:2500H/1:2500V  
Sustainability S8  
Zone  
Development Consent Order

THIS DOCUMENT HAS BEEN PREPARED PURSUANT TO AND SUBJECT TO THE TERMS OF AECOM'S APPOINTMENT BY ITS CLIENT. AECOM ACCEPTS NO LIABILITY FOR ANY USE OF THIS DOCUMENT OTHER THAN BY ITS ORIGINAL CLIENT OR FOLLOWING AECOM'S EXPRESS AGREEMENT TO SUCH USE, AND ONLY FOR THE PURPOSES FOR WHICH IT WAS PREPARED AND PROVIDED.

Drawing Number HE514465 -ACM	Originator -DCO-	Volume -DR-CH-1401	Revision P04
Location Z1_SW_PR_Z	Type I	Role I	Number I

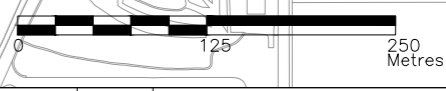



NO PROPOSED WORKS AS PART OF THIS PACKAGE ARE DISPLAYED ON THIS DRAWING

- NOTES
1. THIS DRAWING IS TO BE READ IN CONJUNCTION WITH ALL OTHER RELEVANT DOCUMENTATION.
  2. DO NOT SCALE FROM THIS DRAWING, USE ONLY PRINTED DIMENSIONS.
  3. ALL DIMENSIONS IN MILLIMETRES, ALL CHAINAGES, LEVELS AND COORDINATES ARE IN METRES UNLESS DEFINED OTHERWISE.
  4. THIS DRAWING IS TO BE READ IN CONJUNCTION WITH THE PROJECT HEALTH & SAFETY FILE FOR ANY IDENTIFIED POTENTIAL RISKS.
  5. THE WORKS ARE SHOWN ILLUSTRATIVELY ONLY AND ARE SUBJECT TO CHANGE THROUGH DETAILED DESIGN IN ACCORDANCE WITH THE TERMS OF THE DEVELOPMENT CONSENT ORDER.
  6. AREAS OF EXISTING CARRIAGEWAY TO BE REMOVED ARE SHOWN FOR INFORMATION ONLY. THESE AREAS ARE NOT TO BE STOPPED UP AS THEY WILL REMAIN WITHIN THE PUBLIC HIGHWAY BOUNDARY AND IN SOME CASES DIRECTLY REPLACED WITH NEW HIGHWAY ALIGNMENTS.

- KEY
- LIMITS OF LAND TO BE ACQUIRED OR USED PERMANENTLY OR TEMPORARILY (THE ORDER LIMITS)
  - LAND NOT INCLUDED WITHIN THE ORDER LIMITS
  - EXISTING HIGHWAY TO BE STOPPED UP
  - AREAS OF EXISTING CARRIAGEWAY TO BE REMOVED
  - PROPOSED / IMPROVED PRIVATE MEANS OF ACCESS
  - PROPOSED / IMPROVED MAINTENANCE TRACK
  - EXISTING PRIVATE MEANS OF ACCESS TO BE STOPPED UP
  - EXISTING RIGHT OF WAY (BRIDLEWAY)
  - EXISTING RIGHT OF WAY (FOOTPATH)
  - EXISTING RIGHT OF WAY TO BE REMOVED
  - PROPOSED RIGHT OF WAY (BRIDLEWAY)
  - PROPOSED RIGHT OF WAY (FOOTPATH)
  - PROPOSED FOOTWAY
  - PROPOSED SHARED FOOTWAY / CYCLEWAY
  - PRIVATE MEANS OF ACCESS / RIGHT OF WAY TO BE IMPROVED, CREATED OR STOPPED UP DETAILED IN SCHEDULE 4
  - START / END POINT OF AREA OF EXISTING ROAD TO BE CREATED OR STOPPED UP DETAILED IN SCHEDULE 4
  - PROPOSED STRUCTURE

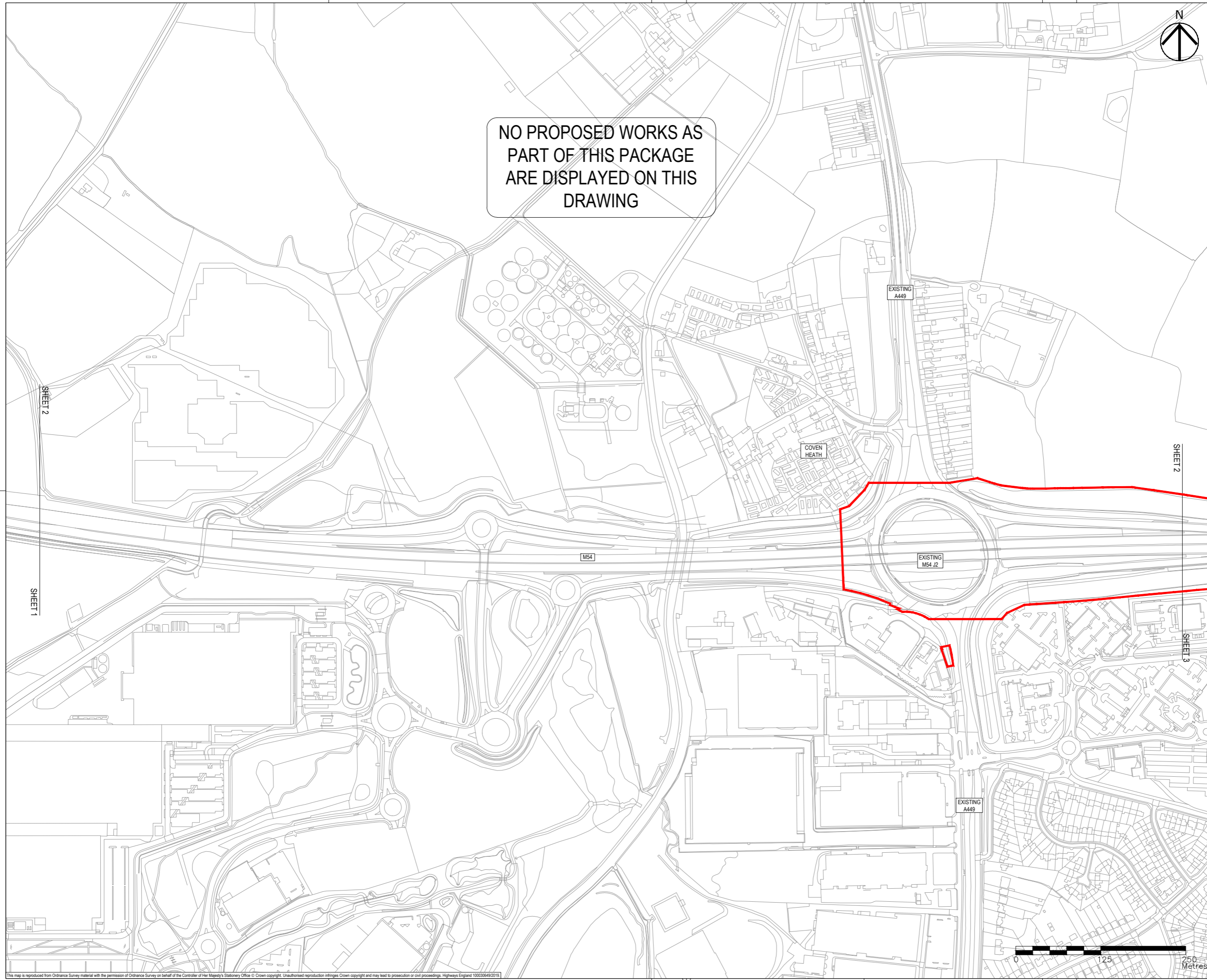

First Issue	MW	RR	06/12/19	P01
Updated following Consultant comments	MW	RR	16/01/20	P02
Revision Details	By	Check	Date	Suffix

Purpose of Issue  
**DCO APPLICATION**

Client  
Highways England  
Floor 5  
Two Colmore Square  
38 Colmore Circus  
Birmingham  
B4 6BN



Development Consent Order Number  
**TR010054**

Project Title  
**M54 to M6 Link Road**

Development Consent Order Drawing Number  
**TR010054/APP/2.7**

Drawing Title  
**STREETS, RIGHTS OF WAY AND ACCESS PLANS REGULATION 5(2)(K) SHEET 2 OF 10**

Designed MW	Drawn MW	Checked AM	Approved RR	Date
60536736				16/01/20
Internal Project No.	Subsidiary		Zone	
Scale @ A1	1:2500H/1:2500V		Development Consent Order	

THIS DOCUMENT HAS BEEN PREPARED PURSUANT TO AND SUBJECT TO THE TERMS OF AECOM'S APPOINTMENT BY ITS CLIENT. AECOM ACCEPTS NO LIABILITY FOR ANY USE OF THIS DOCUMENT OTHER THAN BY ITS ORIGINAL CLIENT OR FOLLOWING AECOM'S EXPRESS AGREEMENT TO SUCH USE, AND ONLY FOR THE PURPOSES FOR WHICH IT WAS PREPARED AND PROVIDED.

Drawing Number	Originator	Volume	Rev
HE514465	-ACM	-DCO-	P02
Location	Type	Role	Number
Z1_SW_PR_Z	-DR-CH-1402		



This map is reproduced from Ordnance Survey material with the permission of Ordnance Survey on behalf of the Controller of Her Majesty's Stationery Office © Crown copyright. Unauthorised reproduction infringes Crown copyright and may lead to prosecution or civil proceedings. Highways England 100030649/2019

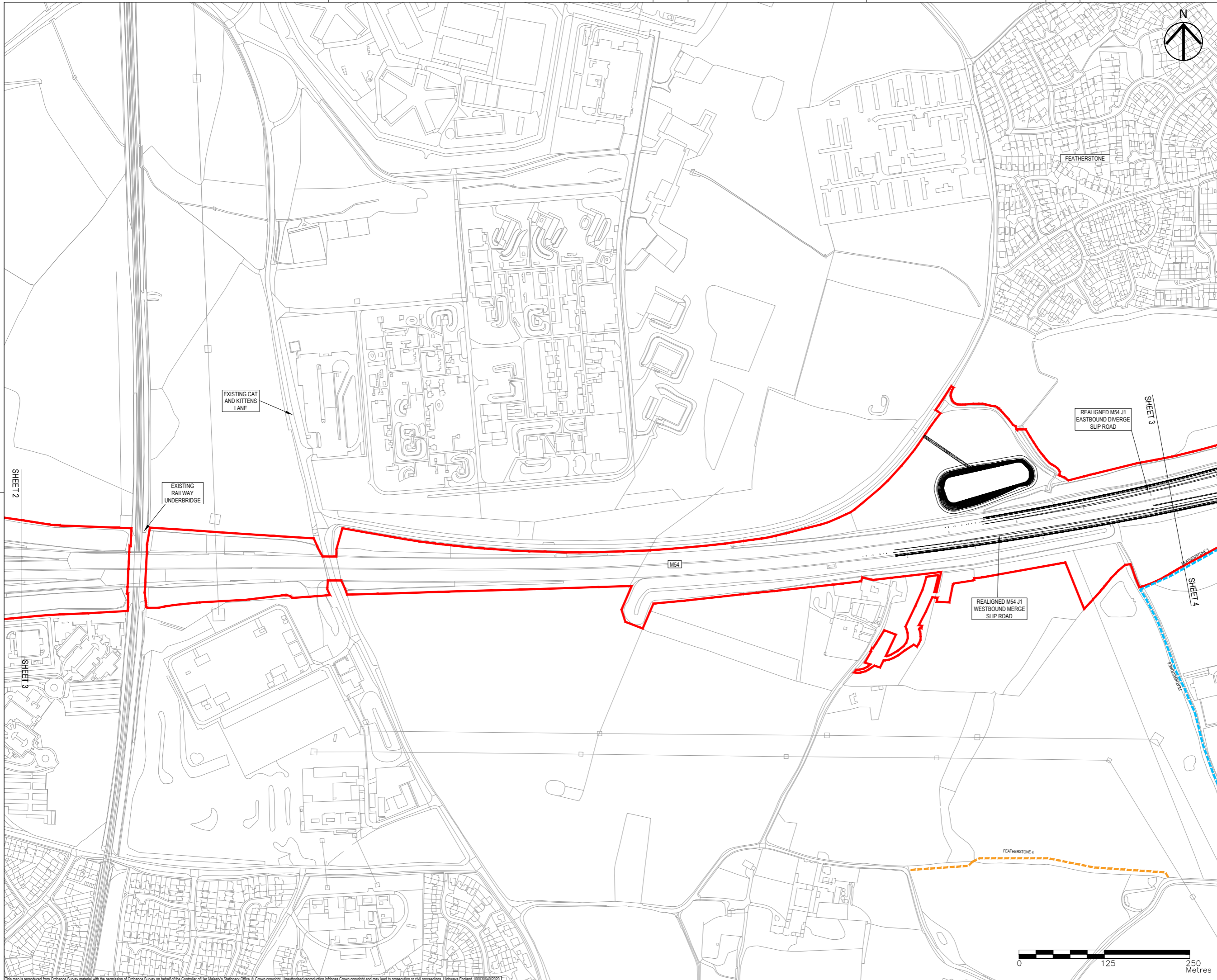

- NOTES**
1. THIS DRAWING IS TO BE READ IN CONJUNCTION WITH ALL OTHER RELEVANT DOCUMENTATION.
  2. DO NOT SCALE FROM THIS DRAWING, USE ONLY PRINTED DIMENSIONS.
  3. ALL DIMENSIONS IN MILLIMETRES, ALL CHAINAGES, LEVELS AND COORDINATES ARE IN METRES UNLESS DEFINED OTHERWISE.
  4. THIS DRAWING IS TO BE READ IN CONJUNCTION WITH THE PROJECT HEALTH & SAFETY FILE FOR ANY IDENTIFIED POTENTIAL RISKS.
  5. THE WORKS ARE SHOWN ILLUSTRATIVELY ONLY AND ARE SUBJECT TO CHANGE THROUGH DETAILED DESIGN IN ACCORDANCE WITH THE TERMS OF THE DEVELOPMENT CONSENT ORDER.
  6. AREAS OF EXISTING CARRIAGEWAY TO BE REMOVED ARE SHOWN FOR INFORMATION ONLY. THESE AREAS ARE NOT TO BE STOPPED UP AS THEY WILL REMAIN WITHIN THE PUBLIC HIGHWAY BOUNDARY AND IN SOME CASES DIRECTLY REPLACED WITH NEW HIGHWAY ALIGNMENTS.

- KEY**
- LIMITS OF LAND TO BE ACQUIRED OR USED PERMANENTLY OR TEMPORARILY (THE ORDER LIMITS)
  - LAND NOT INCLUDED WITHIN THE ORDER LIMITS
  - EXISTING HIGHWAY TO BE STOPPED UP
  - AREAS OF EXISTING CARRIAGEWAY TO BE REMOVED
  - PROPOSED / IMPROVED PRIVATE MEANS OF ACCESS
  - PROPOSED / IMPROVED MAINTENANCE TRACK
  - EXISTING PRIVATE MEANS OF ACCESS TO BE STOPPED UP
  - EXISTING RIGHT OF WAY (BRIDLEWAY)
  - EXISTING RIGHT OF WAY (FOOTPATH)
  - EXISTING RIGHT OF WAY TO BE REMOVED
  - PROPOSED RIGHT OF WAY (BRIDLEWAY)
  - PROPOSED RIGHT OF WAY (FOOTPATH)
  - PROPOSED FOOTWAY
  - PROPOSED SHARED FOOTWAY / CYCLEWAY
  - PRIVATE MEANS OF ACCESS / RIGHT OF WAY TO BE IMPROVED, CREATED OR STOPPED UP DETAILED IN SCHEDULE 4
  - START / END POINT OF AREA OF EXISTING ROAD TO BE CREATED OR STOPPED UP DETAILED IN SCHEDULE 4
  - PROPOSED STRUCTURE

Revision	By	Check	Date	Suffix
First Issue	MW	RR	06/12/19	P01
Updated following Consultee comments	MW	RR	16/01/20	P02
Updated to reflect Oct 2020 scheme changes.	MW	RR	21/09/20	P03

**DCO APPLICATION**

Client  
Highways England  
Floor 5  
Two Colmore Square  
38 Colmore Circus  
Birmingham  
B4 6BN

Development Consent Order Number  
**TR010054**

Project Title  
**M54 to M6 Link Road**

Development Consent Order Drawing Number  
**TR010054/APP/2.7**

**STREETS, RIGHTS OF WAY AND ACCESS PLANS  
REGULATION 5(2)(K)  
SHEET 3 OF 10**

Designed	Draw	Checked	Approved	Date
MW	MW	AM	RR	21/09/20

Internal Project No. 60536736  
Scale @ A1 1:2500H/1:2500V  
Sustainability S8  
Zone Development Consent Order

THIS DOCUMENT HAS BEEN PREPARED PURSUANT TO AND SUBJECT TO THE TERMS OF AECOM'S APPOINTMENT BY ITS CLIENT. AECOM ACCEPTS NO LIABILITY FOR ANY USE OF THIS DOCUMENT OTHER THAN BY ITS ORIGINAL CLIENT OR FOLLOWING AECOM'S EXPRESS AGREEMENT TO SUCH USE, AND ONLY FOR THE PURPOSES FOR WHICH IT WAS PREPARED AND PROVIDED.

Drawing Number <b>HE514465</b>	Highways England PIN <b>-ACM</b>	Originator <b>-DCO-</b>	Volume <b>P03</b>
Location <b>Z1 SW_PR_Z</b>	Type <b>-DR-</b>	Role <b>CH-1403</b>	Number <b>P03</b>

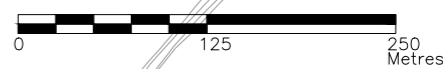

This map is reproduced from Ordnance Survey material with the permission of Ordnance Survey on behalf of the Controller of Her Majesty's Stationary Office © Crown copyright. Unauthorised reproduction infringes Crown copyright and may lead to prosecution or civil proceedings. Highways England 100030649/2020.

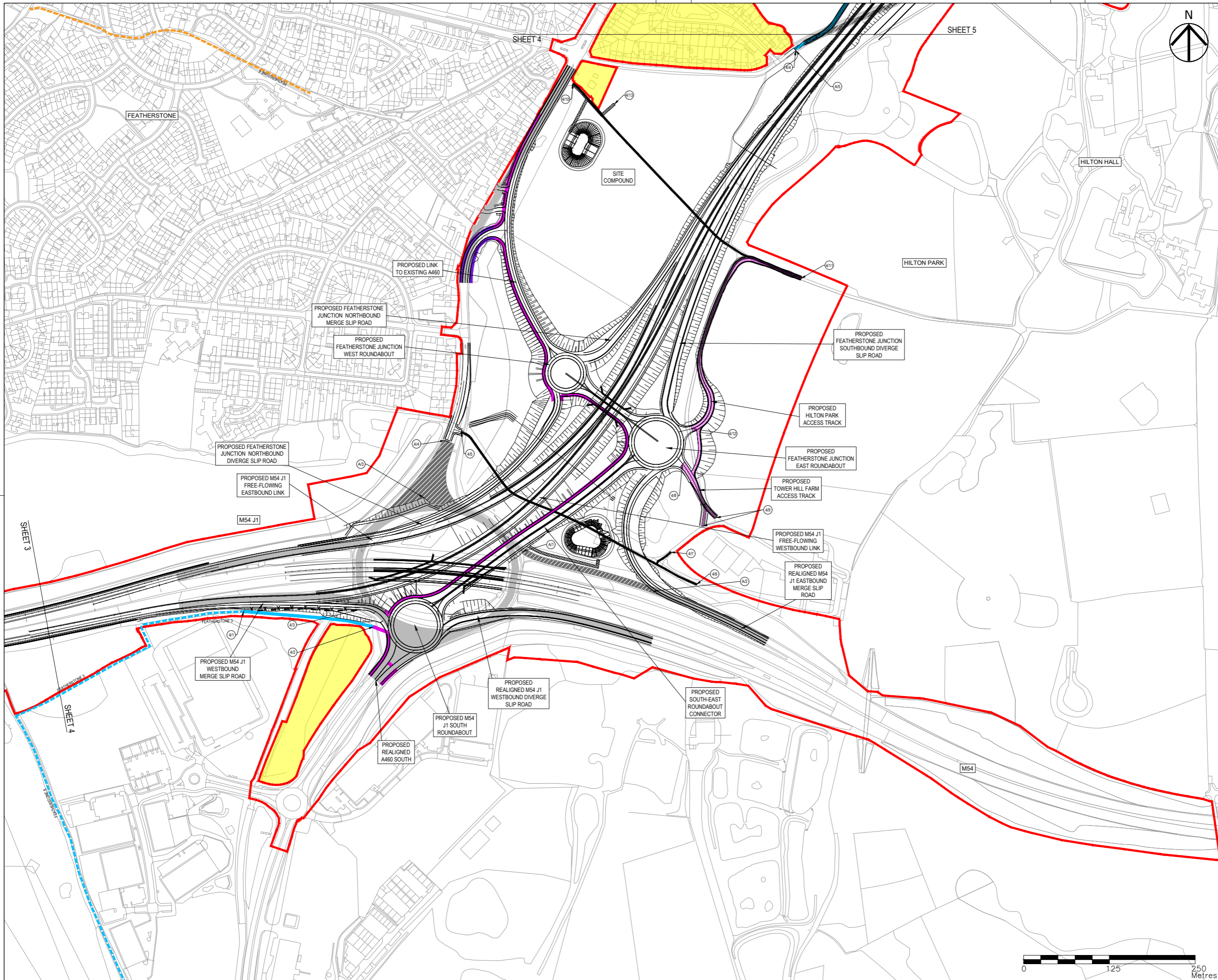

- NOTES**
- THIS DRAWING IS TO BE READ IN CONJUNCTION WITH ALL OTHER RELEVANT DOCUMENTATION.
  - DO NOT SCALE FROM THIS DRAWING, USE ONLY PRINTED DIMENSIONS.
  - ALL DIMENSIONS IN MILLIMETRES, ALL CHAINAGES, LEVELS AND COORDINATES ARE IN METRES UNLESS DEFINED OTHERWISE.
  - THIS DRAWING IS TO BE READ IN CONJUNCTION WITH THE PROJECT HEALTH & SAFETY FILE FOR ANY IDENTIFIED POTENTIAL RISKS.
  - THE WORKS ARE SHOWN ILLUSTRATIVELY ONLY AND ARE SUBJECT TO CHANGE THROUGH DETAILED DESIGN IN ACCORDANCE WITH THE TERMS OF THE DEVELOPMENT CONSENT ORDER.
  - AREAS OF EXISTING CARRIAGEWAY TO BE REMOVED ARE SHOWN FOR INFORMATION ONLY. THESE AREAS ARE NOT TO BE STOPPED UP AS THEY WILL REMAIN WITHIN THE PUBLIC HIGHWAY BOUNDARY AND IN SOME CASES DIRECTLY REPLACED WITH NEW HIGHWAY ALIGNMENTS.

- KEY**
- LIMITS OF LAND TO BE ACQUIRED OR USED PERMANENTLY OR TEMPORARILY (THE ORDER LIMITS)
  - LAND NOT INCLUDED WITHIN THE ORDER LIMITS
  - EXISTING HIGHWAY TO BE STOPPED UP
  - AREAS OF EXISTING CARRIAGEWAY TO BE REMOVED
  - PROPOSED / IMPROVED PRIVATE MEANS OF ACCESS
  - PROPOSED / IMPROVED MAINTENANCE TRACK
  - EXISTING PRIVATE MEANS OF ACCESS TO BE STOPPED UP
  - EXISTING RIGHT OF WAY (BRIDLEWAY)
  - EXISTING RIGHT OF WAY (FOOTPATH)
  - EXISTING RIGHT OF WAY TO BE REMOVED
  - PROPOSED RIGHT OF WAY (BRIDLEWAY)
  - PROPOSED RIGHT OF WAY (FOOTPATH)
  - PROPOSED FOOTWAY
  - PROPOSED SHARED FOOTWAY / CYCLEWAY
  - PRIVATE MEANS OF ACCESS / RIGHT OF WAY TO BE IMPROVED, CREATED OR STOPPED UP DETAILED IN SCHEDULE 4
  - START / END POINT OF AREA OF EXISTING ROAD TO BE CREATED OR STOPPED UP DETAILED IN SCHEDULE 4
  - PROPOSED STRUCTURE

First Issue	MW	RR	06/12/19	P01
Updated following Consultee comments	MW	RR	16/01/20	P02
Minor amendments	MW	RR	21/01/20	P03
Updated to reflect Oct 2020 scheme changes	MW	RR	22/09/20	P04
Minor amendment to PMAs	EL	RR	10/02/21	P05
Revision Details	By	Check	Date	Suffix

**DCO APPLICATION**

Client  
Highways England  
Floor 5  
Two Colmore Square  
38 Colmore Circus  
Birmingham  
B4 6BN

Development Consent Order Number  
**TR010054**

Project Title  
**M54 to M6 Link Road**

Development Consent Order Drawing Number  
**TR010054/APP/2.7**

Drawing Title  
**STREETS, RIGHTS OF WAY AND ACCESS PLANS REGULATION 5(2)(K) SHEET 4 OF 10**

Designed MW	Drawn EL	Checked AM	Approved RR	Date 10/02/21
Internal Project No. 60536736	Suitability S8		Zone	
Scale @ A1 1:2500H/1:2500V	Development Consent Order			

THIS DOCUMENT HAS BEEN PREPARED PURSUANT TO AND SUBJECT TO THE TERMS OF AECOM'S APPOINTMENT BY ITS CLIENT. AECOM ACCEPTS NO LIABILITY FOR ANY USE OF THIS DOCUMENT OTHER THAN BY ITS ORIGINAL CLIENT OR FOLLOWING AECOM'S EXPRESS AGREEMENT TO SUCH USE, AND ONLY FOR THE PURPOSES FOR WHICH IT WAS PREPARED AND PROVIDED.

Drawing Number HE514465 -ACM	Originator -DCO-	Volume Z1 SW_PR_Z	Rev P05
Location Z1 SW_PR_Z	Type -DR-CH-1404	Role I	Number I

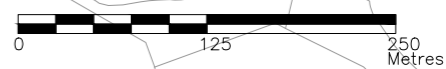

This map is reproduced from Ordnance Survey material with the permission of Ordnance Survey on behalf of the Controller of Her Majesty's Stationery Office © Crown copyright. Unauthorised reproduction infringes Crown copyright and may lead to prosecution or civil proceedings. Highways England 100030649/2020



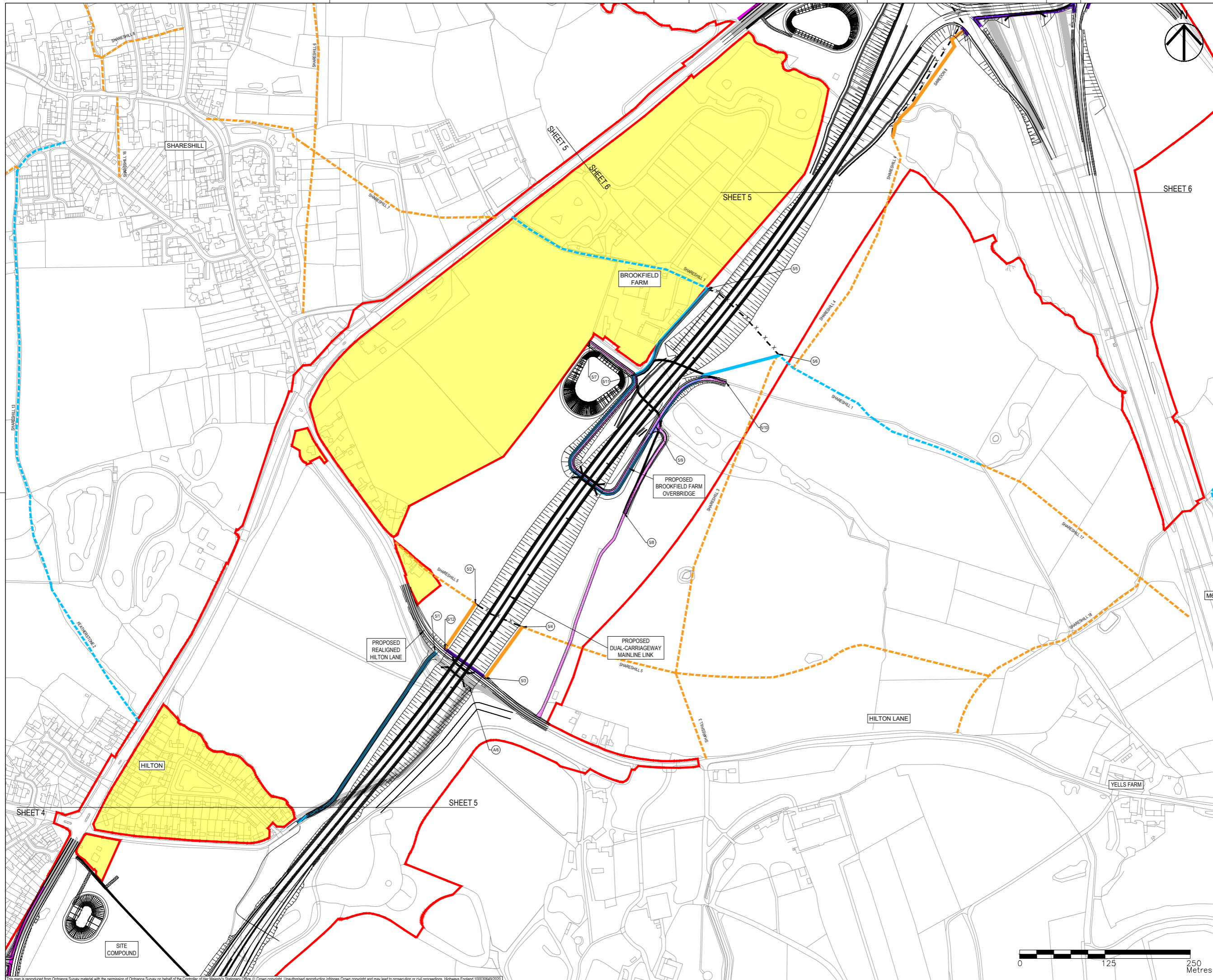

- NOTES**
- THIS DRAWING IS TO BE READ IN CONJUNCTION WITH ALL OTHER RELEVANT DOCUMENTATION.
  - DO NOT SCALE FROM THIS DRAWING, USE ONLY PRINTED DIMENSIONS.
  - ALL DIMENSIONS IN MILLIMETRES, ALL CHAINAGES, LEVELS AND COORDINATES ARE IN METRES UNLESS DEFINED OTHERWISE.
  - THIS DRAWING IS TO BE READ IN CONJUNCTION WITH THE PROJECT HEALTH & SAFETY FILE FOR ANY IDENTIFIED POTENTIAL RISKS.
  - THE WORKS ARE SHOWN ILLUSTRATIVELY ONLY AND ARE SUBJECT TO CHANGE THROUGH DETAILED DESIGN IN ACCORDANCE WITH THE TERMS OF THE DEVELOPMENT CONSENT ORDER.
  - AREAS OF EXISTING CARRIAGEWAY TO BE REMOVED ARE SHOWN FOR INFORMATION ONLY. THESE AREAS ARE NOT TO BE STOPPED UP AS THEY WILL REMAIN WITHIN THE PUBLIC HIGHWAY BOUNDARY AND IN SOME CASES DIRECTLY REPLACED WITH NEW HIGHWAY ALIGNMENTS.

- KEY**
- LIMITS OF LAND TO BE ACQUIRED OR USED PERMANENTLY OR TEMPORARILY (THE ORDER LIMITS)
  - LAND NOT INCLUDED WITHIN THE ORDER LIMITS
  - EXISTING HIGHWAY TO BE STOPPED UP
  - AREAS OF EXISTING CARRIAGEWAY TO BE REMOVED
  - PROPOSED / IMPROVED PRIVATE MEANS OF ACCESS
  - PROPOSED / IMPROVED MAINTENANCE TRACK
  - EXISTING PRIVATE MEANS OF ACCESS TO BE STOPPED UP
  - EXISTING RIGHT OF WAY (BRIDLEWAY)
  - EXISTING RIGHT OF WAY (FOOTPATH)
  - EXISTING RIGHT OF WAY TO BE REMOVED
  - PROPOSED RIGHT OF WAY (BRIDLEWAY)
  - PROPOSED RIGHT OF WAY (FOOTPATH)
  - PROPOSED FOOTWAY
  - PROPOSED SHARED FOOTWAY / CYCLEWAY
  - PRIVATE MEANS OF ACCESS / RIGHT OF WAY TO BE IMPROVED, CREATED OR STOPPED UP DETAILED IN SCHEDULE 4
  - START / END POINT OF AREA OF EXISTING ROAD TO BE CREATED OR STOPPED UP DETAILED IN SCHEDULE 4
  - PROPOSED STRUCTURE

First Issue	MW	RR	06/12/19	P01
Updated following Consultee comments	MW	RR	16/01/20	P02
Minor amendments	MW	RR	21/01/20	P03
Updated to reflect Oct 2020 scheme changes	MW	RR	21/09/20	P04
Minor amendment to proposed Saredon & Right of Way route	MW	RR	06/10/20	P05
Minor amendment to PMAs	MW	RR	12/02/21	P06
Revision Details	By	Check	Date	Suffix

**DCO APPLICATION**

Client  
Highways England  
Floor 5  
Two Colmore Square  
38 Colmore Circus  
Birmingham  
B4 6BN

Development Consent Order Number  
**TR010054**

Project Title  
**M54 to M6 Link Road**

Development Consent Order Drawing Number  
**TR010054/APP/2.7**

Drawing Title  
**STREETS, RIGHTS OF WAY AND ACCESS PLANS REGULATION 5(2)(K) SHEET 5 OF 10**

Designed MW	Drawn MW	Checked AM	Approved RR	Date
60536736				12/02/21
Scale @ A1	1:2500H/1:2500V	Zone	Development Consent Order	

THIS DOCUMENT HAS BEEN PREPARED PURSUANT TO AND SUBJECT TO THE TERMS OF AECOM'S APPOINTMENT BY ITS CLIENT. AECOM ACCEPTS NO LIABILITY FOR ANY USE OF THIS DOCUMENT OTHER THAN BY ITS ORIGINAL CLIENT OR FOLLOWING AECOM'S EXPRESS AGREEMENT TO SUCH USE, AND ONLY FOR THE PURPOSES FOR WHICH IT WAS PREPARED AND PROVIDED.

Drawing Number	Highways England PIN	1 Originator	1 Volume	Rev
HE514465	-ACM	-DCO-		P06
Z2 SW_PR_Z		-DR-CH-1405		
Local	1 Type	1 Role	1 Number	



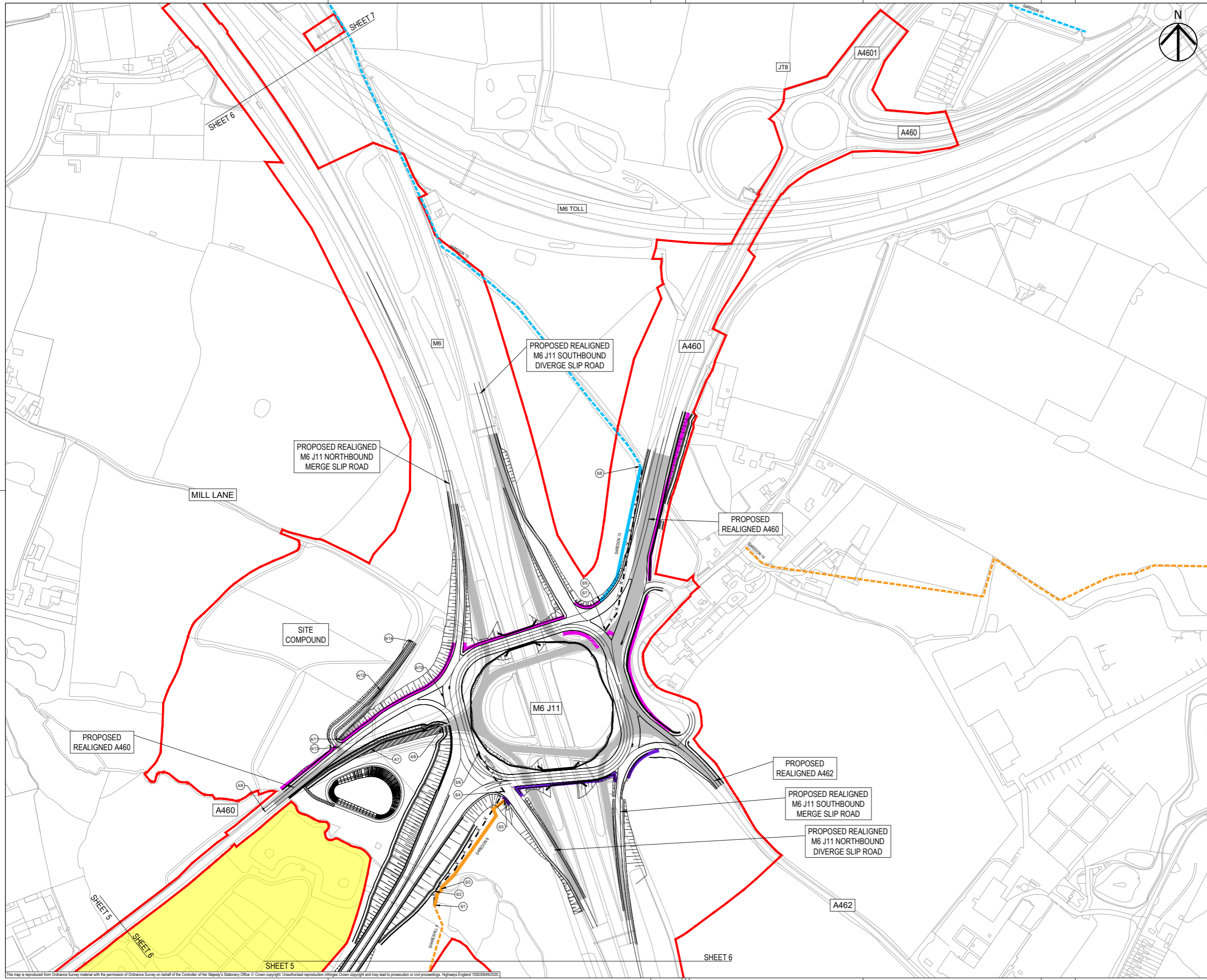

- NOTES**
- THIS DRAWING IS TO BE READ IN CONJUNCTION WITH ALL OTHER RELEVANT DOCUMENTATION.
  - DO NOT SCALE FROM THIS DRAWING, USE ONLY PRINTED DIMENSIONS.
  - ALL DIMENSIONS IN MILLIMETRES, ALL CHAINAGES, LEVELS AND COORDINATES ARE IN METRES UNLESS DEFINED OTHERWISE.
  - THIS DRAWING IS TO BE READ IN CONJUNCTION WITH THE PROJECT HEALTH & SAFETY FILE FOR ANY IDENTIFIED POTENTIAL RISKS.
  - THE WORKS ARE SHOWN ILLUSTRATIVELY ONLY AND ARE SUBJECT TO CHANGE THROUGH DETAILED DESIGN IN ACCORDANCE WITH THE TERMS OF THE DEVELOPMENT CONSENT ORDER.
  - AREAS OF EXISTING CARRIAGEWAY TO BE REMOVED ARE SHOWN FOR INFORMATION ONLY. THESE AREAS ARE NOT TO BE STOPPED UP AS THEY WILL REMAIN WITHIN THE PUBLIC HIGHWAY BOUNDARY AND IN SOME CASES DIRECTLY REPLACED WITH NEW HIGHWAY ALIGNMENTS.

- KEY**
- LIMITS OF LAND TO BE ACQUIRED OR USED PERMANENTLY OR TEMPORARILY (THE ORDER LIMITS)
  - LAND NOT INCLUDED WITHIN THE ORDER LIMITS
  - EXISTING HIGHWAY TO BE STOPPED UP
  - AREAS OF EXISTING CARRIAGEWAY TO BE REMOVED
  - PROPOSED / IMPROVED PRIVATE MEANS OF ACCESS
  - PROPOSED / IMPROVED MAINTENANCE TRACK
  - EXISTING PRIVATE MEANS OF ACCESS TO BE STOPPED UP
  - EXISTING RIGHT OF WAY (BRIDLEWAY)
  - EXISTING RIGHT OF WAY (FOOTPATH)
  - EXISTING RIGHT OF WAY TO BE REMOVED
  - PROPOSED RIGHT OF WAY (BRIDLEWAY)
  - PROPOSED RIGHT OF WAY (FOOTPATH)
  - PROPOSED FOOTWAY
  - PROPOSED SHARED FOOTWAY / CYCLEWAY
  - PRIVATE MEANS OF ACCESS / RIGHT OF WAY TO BE IMPROVED, CREATED OR STOPPED UP DETAILED IN SCHEDULE 4
  - START / END POINT OF AREA OF EXISTING ROAD TO BE CREATED OR STOPPED UP DETAILED IN SCHEDULE 4
  - PROPOSED STRUCTURE

Revision Details	By	Check	Date	Suffix
First Issue	MW	RR	06/12/19	P01
Updated following Consultee comments	MW	RR	16/01/20	P02
Updated to reflect Oct 2020 scheme changes.	MW	RR	21/09/20	P03
Minor amendment to proposed Saredon 8 Right of Way route	MW	RR	06/10/20	P04

**DCO APPLICATION**

Client  
 Highways England  
 Floor 5  
 Two Colmore Square  
 38 Colmore Circus  
 Birmingham  
 B4 6BN

Development Consent Order Number  
**TR010054**

Project Title  
**M54 to M6 Link Road**

Development Consent Order Drawing Number  
**TR010054/APP/2.7**

Drawing Title  
**STREETS, RIGHTS OF WAY AND ACCESS PLANS REGULATION 5(2)(K) SHEET 6 OF 10**

Designed	Drawn	Checked	Approved	Date
MW	MW	AM	RR	06/10/20

Internal Project No. 60536736  
 Scale @ A1 1:2500H/1:2500V  
 Suitability S8  
 Zone Development Consent Order

THIS DOCUMENT HAS BEEN PREPARED PURSUANT TO AND SUBJECT TO THE TERMS OF AECOM'S APPOINTMENT BY ITS CLIENT. AECOM ACCEPTS NO LIABILITY FOR ANY USE OF THIS DOCUMENT OTHER THAN BY ITS ORIGINAL CLIENT OR FOLLOWING AECOM'S EXPRESS AGREEMENT TO SUCH USE, AND ONLY FOR THE PURPOSES FOR WHICH IT WAS PREPARED AND PROVIDED.

Drawing Number HE514465	Highways England PIN -ACM	Originator -DCO-	Volume Z3 SW_PR_Z	Rev P04
Location	Type	Role	Number	

This map is reproduced from Ordnance Survey material with the permission of Ordnance Survey on behalf of the Controller of Her Majesty's Stationery Office © Crown copyright. Unauthorised reproduction infringes Crown copyright and may lead to prosecution or civil proceedings. Highways England 100030649/2020

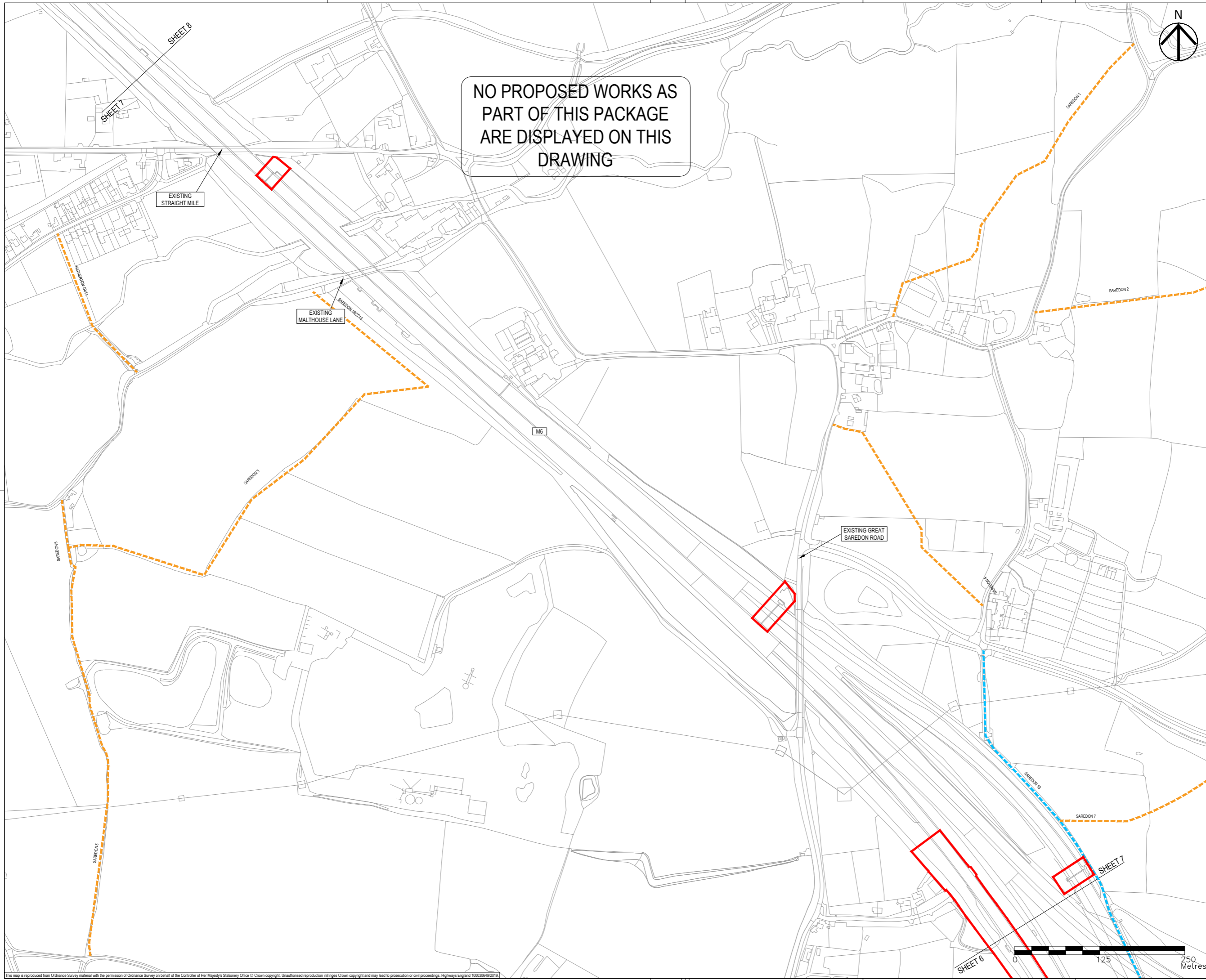

NO PROPOSED WORKS AS PART OF THIS PACKAGE ARE DISPLAYED ON THIS DRAWING

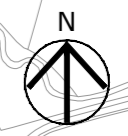

- NOTES
1. THIS DRAWING IS TO BE READ IN CONJUNCTION WITH ALL OTHER RELEVANT DOCUMENTATION.
  2. DO NOT SCALE FROM THIS DRAWING, USE ONLY PRINTED DIMENSIONS.
  3. ALL DIMENSIONS IN MILLIMETRES, ALL CHAINAGES, LEVELS AND COORDINATES ARE IN METRES UNLESS DEFINED OTHERWISE.
  4. THIS DRAWING IS TO BE READ IN CONJUNCTION WITH THE PROJECT HEALTH & SAFETY FILE FOR ANY IDENTIFIED POTENTIAL RISKS.
  5. THE WORKS ARE SHOWN ILLUSTRATIVELY ONLY AND ARE SUBJECT TO CHANGE THROUGH DETAILED DESIGN IN ACCORDANCE WITH THE TERMS OF THE DEVELOPMENT CONSENT ORDER.
  6. AREAS OF EXISTING CARRIAGEWAY TO BE REMOVED ARE SHOWN FOR INFORMATION ONLY. THESE AREAS ARE NOT TO BE STOPPED UP AS THEY WILL REMAIN WITHIN THE PUBLIC HIGHWAY BOUNDARY AND IN SOME CASES DIRECTLY REPLACED WITH NEW HIGHWAY ALIGNMENTS.

- KEY
- LIMITS OF LAND TO BE ACQUIRED OR USED PERMANENTLY OR TEMPORARILY (THE ORDER LIMITS)
  - LAND NOT INCLUDED WITHIN THE ORDER LIMITS
  - EXISTING HIGHWAY TO BE STOPPED UP
  - AREAS OF EXISTING CARRIAGEWAY TO BE REMOVED
  - PROPOSED / IMPROVED PRIVATE MEANS OF ACCESS
  - PROPOSED / IMPROVED MAINTENANCE TRACK
  - EXISTING PRIVATE MEANS OF ACCESS TO BE STOPPED UP
  - EXISTING RIGHT OF WAY (BRIDLEWAY)
  - EXISTING RIGHT OF WAY (FOOTPATH)
  - EXISTING RIGHT OF WAY TO BE REMOVED
  - PROPOSED RIGHT OF WAY (BRIDLEWAY)
  - PROPOSED RIGHT OF WAY (FOOTPATH)
  - PROPOSED FOOTWAY
  - PROPOSED SHARED FOOTWAY / CYCLEWAY
  - PRIVATE MEANS OF ACCESS / RIGHT OF WAY TO BE IMPROVED, CREATED OR STOPPED UP DETAILED IN SCHEDULE 4
  - START / END POINT OF AREA OF EXISTING ROAD TO BE CREATED OR STOPPED UP DETAILED IN SCHEDULE 4
  - PROPOSED STRUCTURE

First Issue	MW	RR	06/12/19	P01
Updated following Consultee comments	MW	RR	16/01/20	P02
Revision Details	By	Check	Date	Suffix

Purpose of issue  
**DCO APPLICATION**

Client  
Highways England  
Floor 5  
Two Colmore Square  
38 Colmore Circus  
Birmingham  
B4 6BN

Development Consent Order Number  
**TR010054**

Project Title  
**M54 to M6 Link Road**

Development Consent Order Drawing Number  
**TR010054/APP/2.7**

Drawing Title  
**STREETS, RIGHTS OF WAY AND ACCESS PLANS REGULATION 5(2)(K) SHEET 7 OF 10**

Designed MW	Drawn MW	Checked AM	Approved RR	Date 16/01/20
Internal Project No. 60536736	Suitability SB	Scale @ A1 1:2500H/1:2500V		
Development Consent Order				Zone

THIS DOCUMENT HAS BEEN PREPARED PURSUANT TO AND SUBJECT TO THE TERMS OF AECOM'S APPOINTMENT BY ITS CLIENT. AECOM ACCEPTS NO LIABILITY FOR ANY USE OF THIS DOCUMENT OTHER THAN BY ITS ORIGINAL CLIENT OR FOLLOWING AECOM'S EXPRESS AGREEMENT TO SUCH USE, AND ONLY FOR THE PURPOSES FOR WHICH IT WAS PREPARED AND PROVIDED.

Drawing Number HE514465 -ACM	Originator -DCO-	Volume -DR-CH-1407	Rev P02
Location Z3_SW_PR_Z	Type 1	Role 1	Number 1

This map is reproduced from Ordnance Survey material with the permission of Ordnance Survey on behalf of the Controller of Her Majesty's Stationary Office © Crown copyright. Unauthorised reproduction infringes Crown copyright and may lead to prosecution or civil proceedings. Highways England 100030649/2019

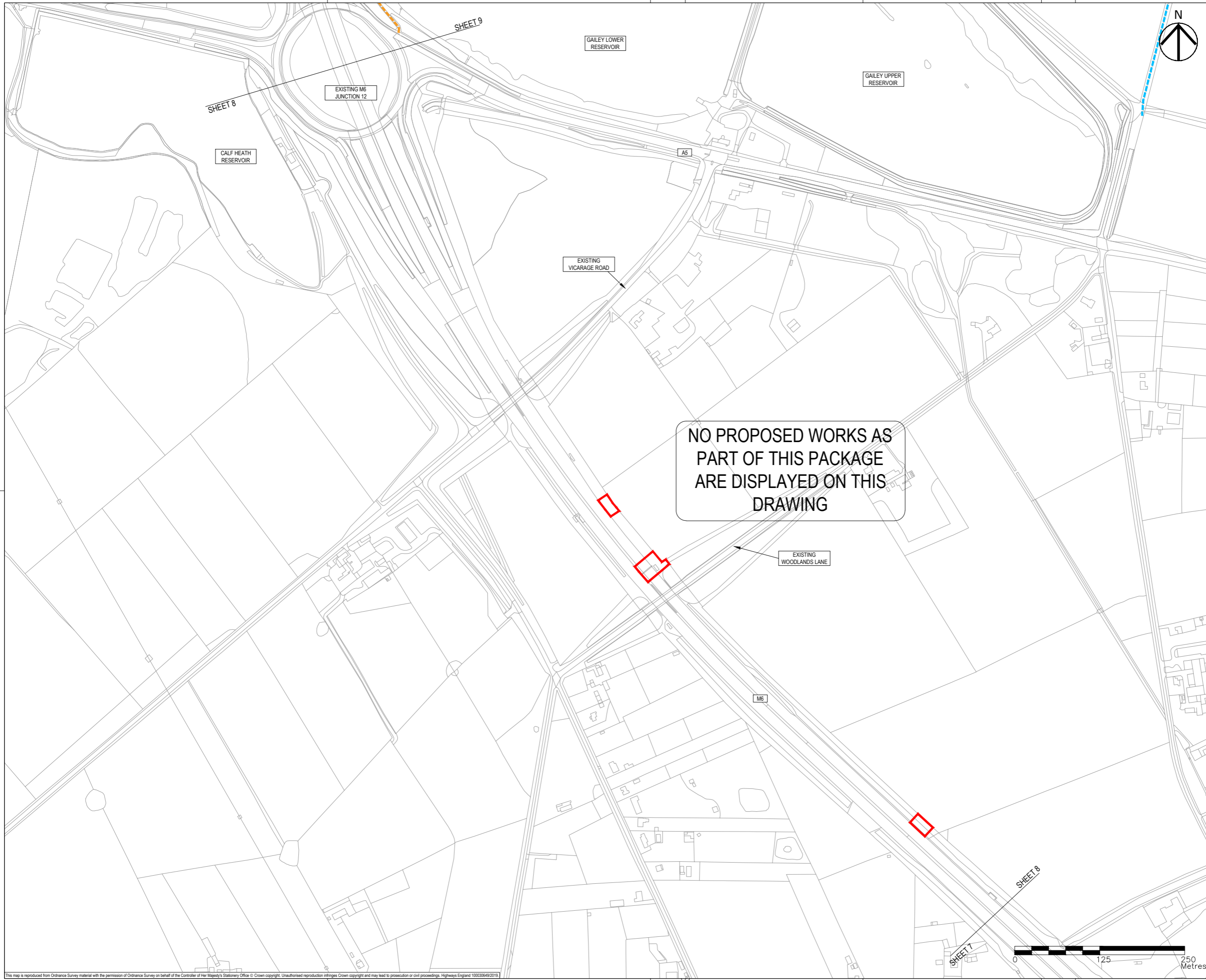

- NOTES**
- THIS DRAWING IS TO BE READ IN CONJUNCTION WITH ALL OTHER RELEVANT DOCUMENTATION.
  - DO NOT SCALE FROM THIS DRAWING, USE ONLY PRINTED DIMENSIONS.
  - ALL DIMENSIONS IN MILLIMETRES, ALL CHAINAGES, LEVELS AND COORDINATES ARE IN METRES UNLESS DEFINED OTHERWISE.
  - THIS DRAWING IS TO BE READ IN CONJUNCTION WITH THE PROJECT HEALTH & SAFETY FILE FOR ANY IDENTIFIED POTENTIAL RISKS.
  - THE WORKS ARE SHOWN ILLUSTRATIVELY ONLY AND ARE SUBJECT TO CHANGE THROUGH DETAILED DESIGN IN ACCORDANCE WITH THE TERMS OF THE DEVELOPMENT CONSENT ORDER.
  - AREAS OF EXISTING CARRIAGEWAY TO BE REMOVED ARE SHOWN FOR INFORMATION ONLY. THESE AREAS ARE NOT TO BE STOPPED UP AS THEY WILL REMAIN WITHIN THE PUBLIC HIGHWAY BOUNDARY AND IN SOME CASES DIRECTLY REPLACED WITH NEW HIGHWAY ALIGNMENTS.

- KEY**
- LIMITS OF LAND TO BE ACQUIRED OR USED PERMANENTLY OR TEMPORARILY (THE ORDER LIMITS)
  - LAND NOT INCLUDED WITHIN THE ORDER LIMITS
  - EXISTING HIGHWAY TO BE STOPPED UP
  - AREAS OF EXISTING CARRIAGEWAY TO BE REMOVED
  - PROPOSED / IMPROVED PRIVATE MEANS OF ACCESS
  - PROPOSED / IMPROVED MAINTENANCE TRACK
  - EXISTING PRIVATE MEANS OF ACCESS TO BE STOPPED UP
  - EXISTING RIGHT OF WAY (BRIDLEWAY)
  - EXISTING RIGHT OF WAY (FOOTPATH)
  - EXISTING RIGHT OF WAY TO BE REMOVED
  - PROPOSED RIGHT OF WAY (BRIDLEWAY)
  - PROPOSED RIGHT OF WAY (FOOTPATH)
  - PROPOSED FOOTWAY
  - PROPOSED SHARED FOOTWAY / CYCLEWAY
  - PRIVATE MEANS OF ACCESS / RIGHT OF WAY TO BE IMPROVED, CREATED OR STOPPED UP DETAILED IN SCHEDULE 4
  - START / END POINT OF AREA OF EXISTING ROAD TO BE CREATED OR STOPPED UP DETAILED IN SCHEDULE 4
  - PROPOSED STRUCTURE

NO PROPOSED WORKS AS PART OF THIS PACKAGE ARE DISPLAYED ON THIS DRAWING

First Issue	MW	RR	06/12/19	P01
Updated following Consultee comments	MW	RR	16/01/20	P02
Revision Details	By	Check	Date	Suffix

**DCO APPLICATION**

Client  
**Highways England**  
 Floor 5  
 Two Colmore Square  
 38 Colmore Circus  
 Birmingham  
 B4 6BN

Development Consent Order Number  
**TR010054**

Project Title  
**M54 to M6 Link Road**

Development Consent Order Drawing Number  
**TR010054/APP/2.7**

Drawing Title  
**STREETS, RIGHTS OF WAY AND ACCESS PLANS  
 REGULATION 5(2)(K)  
 SHEET 8 OF 10**

Designed	Drawn	Checked	Approved	Date
MW	MW	AM	RR	16/01/20
Internal Project No.	Sustainability			
60536736	SB			
Scale @ A1	Zone			
1:2500H/1:2500V	Development Consent Order			

THIS DOCUMENT HAS BEEN PREPARED PURSUANT TO AND SUBJECT TO THE TERMS OF AECOM'S APPOINTMENT BY ITS CLIENT. AECOM ACCEPTS NO LIABILITY FOR ANY USE OF THIS DOCUMENT OTHER THAN BY ITS ORIGINAL CLIENT OR FOLLOWING AECOM'S EXPRESS AGREEMENT TO SUCH USE, AND ONLY FOR THE PURPOSES FOR WHICH IT WAS PREPARED AND PROVIDED.

Drawing Number	Highways England PIN	Originator	Volume	Rev
HE514465	-ACM	-DCO-		P02
Z3_SW_PR_Z		-DR-CH-1408		
Location	Type	Role	Number	

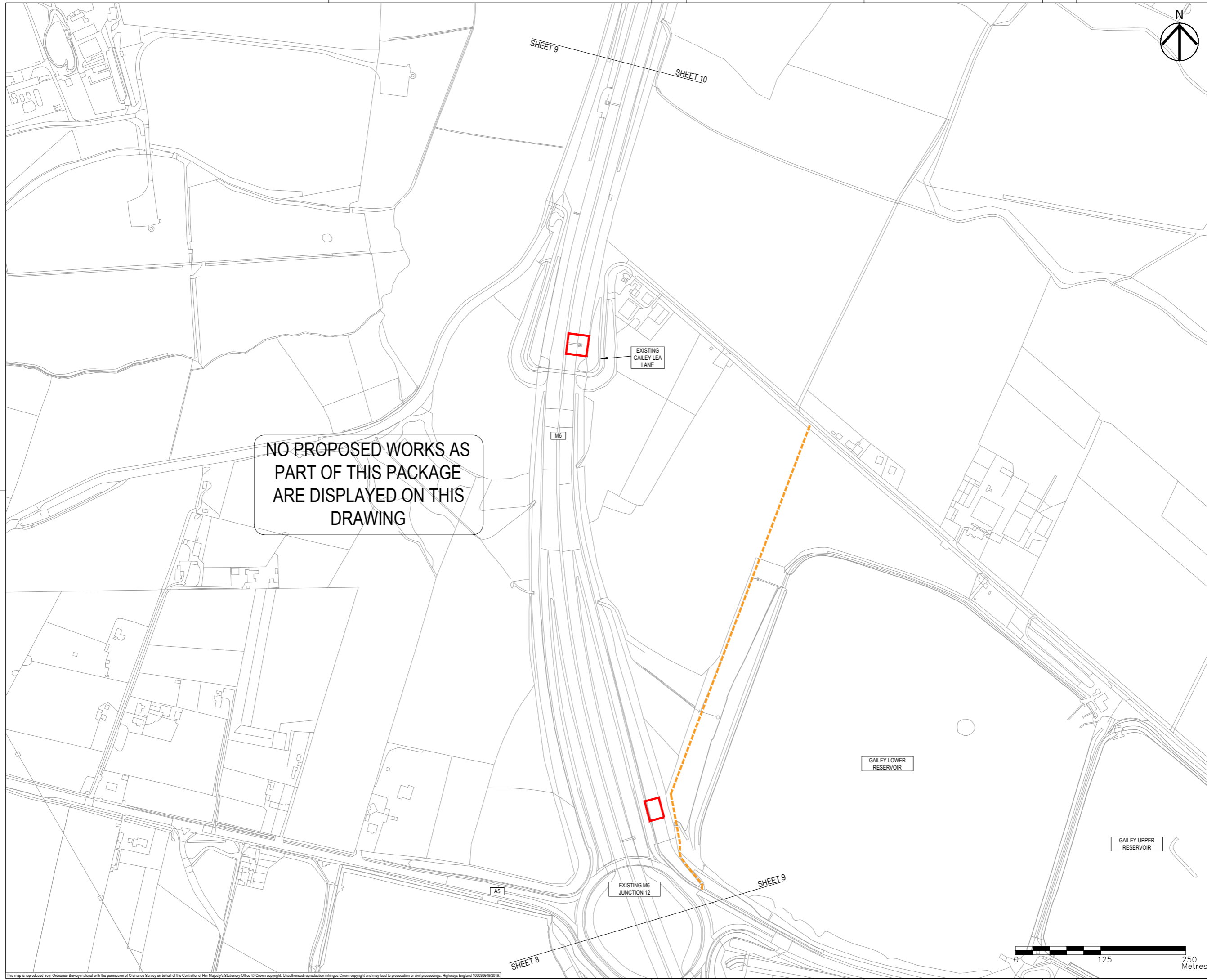

NO PROPOSED WORKS AS PART OF THIS PACKAGE ARE DISPLAYED ON THIS DRAWING



- NOTES**
- THIS DRAWING IS TO BE READ IN CONJUNCTION WITH ALL OTHER RELEVANT DOCUMENTATION.
  - DO NOT SCALE FROM THIS DRAWING, USE ONLY PRINTED DIMENSIONS.
  - ALL DIMENSIONS IN MILLIMETRES, ALL CHAINAGES, LEVELS AND COORDINATES ARE IN METRES UNLESS DEFINED OTHERWISE.
  - THIS DRAWING IS TO BE READ IN CONJUNCTION WITH THE PROJECT HEALTH & SAFETY FILE FOR ANY IDENTIFIED POTENTIAL RISKS.
  - THE WORKS ARE SHOWN ILLUSTRATIVELY ONLY AND ARE SUBJECT TO CHANGE THROUGH DETAILED DESIGN IN ACCORDANCE WITH THE TERMS OF THE DEVELOPMENT CONSENT ORDER.
  - AREAS OF EXISTING CARRIAGEWAY TO BE REMOVED ARE SHOWN FOR INFORMATION ONLY. THESE AREAS ARE NOT TO BE STOPPED UP AS THEY WILL REMAIN WITHIN THE PUBLIC HIGHWAY BOUNDARY AND IN SOME CASES DIRECTLY REPLACED WITH NEW HIGHWAY ALIGNMENTS.

- KEY**
- LIMITS OF LAND TO BE ACQUIRED OR USED PERMANENTLY OR TEMPORARILY (THE ORDER LIMITS)
  - LAND NOT INCLUDED WITHIN THE ORDER LIMITS
  - EXISTING HIGHWAY TO BE STOPPED UP
  - AREAS OF EXISTING CARRIAGEWAY TO BE REMOVED
  - PROPOSED / IMPROVED PRIVATE MEANS OF ACCESS
  - PROPOSED / IMPROVED MAINTENANCE TRACK
  - EXISTING PRIVATE MEANS OF ACCESS TO BE STOPPED UP
  - EXISTING RIGHT OF WAY (BRIDLEWAY)
  - EXISTING RIGHT OF WAY (FOOTPATH)
  - EXISTING RIGHT OF WAY TO BE REMOVED
  - PROPOSED RIGHT OF WAY (BRIDLEWAY)
  - PROPOSED RIGHT OF WAY (FOOTPATH)
  - PROPOSED SHARED FOOTWAY / CYCLEWAY
  - PRIVATE MEANS OF ACCESS / RIGHT OF WAY TO BE IMPROVED, CREATED OR STOPPED UP DETAILED IN SCHEDULE 4
  - START / END POINT OF AREA OF EXISTING ROAD TO BE CREATED OR STOPPED UP DETAILED IN SCHEDULE 4
  - PROPOSED STRUCTURE

First Issue	MW	RR	06/12/19	P01
Updated following Consultee comments	MW	RR	16/01/20	P02
Revision Details	By	Check	Date	Suffix

**Purpose of Issue**  
DCO APPLICATION

**Client**  
Highways England  
Floor 5  
Two Colmore Square  
38 Colmore Circus  
Birmingham  
B4 6BN

**Development Consent Order Number**  
TR010054

**Project Title**  
M54 to M6 Link Road

**Development Consent Order Drawing Number**  
TR010054/APP/2.7

**Drawing Title**  
STREETS, RIGHTS OF WAY AND ACCESS PLANS REGULATION 5(2)(K) SHEET 9 OF 10

Designed MW	Drawn MW	Checked AM	Approved RR	Date
60536736				16/01/20
Internal Project No.	Suitability			
Scale @ A1	Zone			
1:2500H/1:2500V	Development Consent Order			

THIS DOCUMENT HAS BEEN PREPARED PURSUANT TO AND SUBJECT TO THE TERMS OF AECOM'S APPOINTMENT BY ITS CLIENT. AECOM ACCEPTS NO LIABILITY FOR ANY USE OF THIS DOCUMENT OTHER THAN BY ITS ORIGINAL CLIENT OR FOLLOWING AECOM'S EXPRESS AGREEMENT TO SUCH USE, AND ONLY FOR THE PURPOSES FOR WHICH IT WAS PREPARED AND PROVIDED.

Drawing Number	Highways England PIN	Originator	Volume	Rev
HE514465	-ACM	-DCO-		P02
Z3_SW_PR_Z		-DR-CH-1409		
Location	Type	Role	Number	

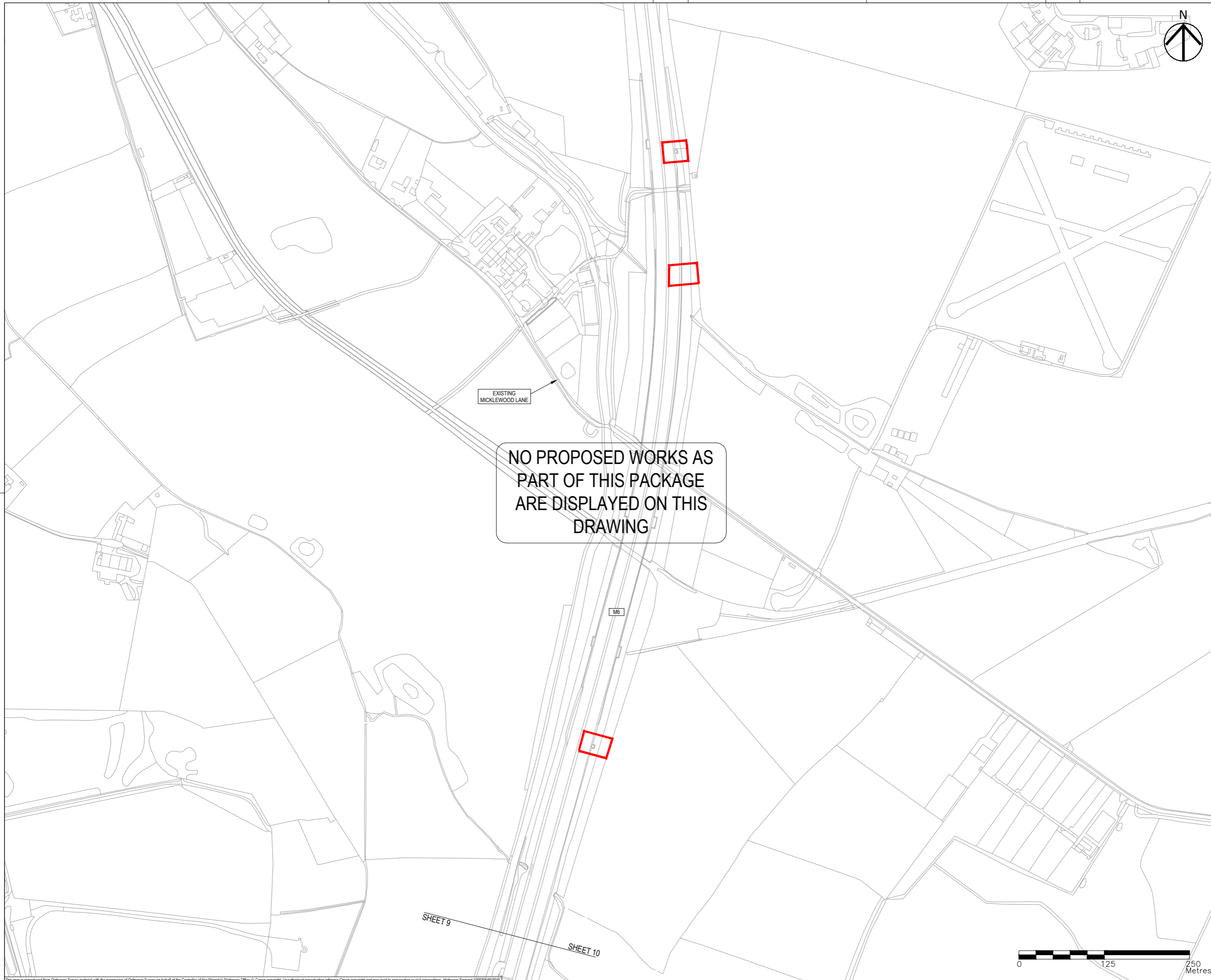

NO PROPOSED WORKS AS  
PART OF THIS PACKAGE  
ARE DISPLAYED ON THIS  
DRAWING

- NOTES**
1. THIS DRAWING IS TO BE READ IN CONJUNCTION WITH ALL OTHER RELEVANT DOCUMENTATION.
  2. DO NOT SCALE FROM THIS DRAWING, USE ONLY PRINTED DIMENSIONS.
  3. ALL DIMENSIONS IN MILLIMETRES, ALL CHAINAGES, LEVELS AND COORDINATES ARE IN METRES UNLESS DEFINED OTHERWISE.
  4. THIS DRAWING IS TO BE READ IN CONJUNCTION WITH THE PROJECT HEALTH & SAFETY FILE FOR ANY IDENTIFIED POTENTIAL RISKS.
  5. THE WORKS ARE SHOWN ILLUSTRATIVELY ONLY AND ARE SUBJECT TO CHANGE THROUGH DETAILED DESIGN IN ACCORDANCE WITH THE TERMS OF THE DEVELOPMENT CONSENT ORDER.
  6. AREAS OF EXISTING CARRIAGEWAY TO BE REMOVED ARE SHOWN FOR INFORMATION ONLY. THESE AREAS ARE NOT TO BE STOPPED UP AS THEY WILL REMAIN WITHIN THE PUBLIC HIGHWAY BOUNDARY AND IN SOME CASES DIRECTLY REPLACED WITH NEW HIGHWAY ALIGNMENTS.

- KEY**
- LIMITS OF LAND TO BE ACQUIRED OR USED PERMANENTLY OR TEMPORARILY (THE ORDER LIMITS)
  - LAND NOT INCLUDED WITHIN THE ORDER LIMITS
  - EXISTING HIGHWAY TO BE STOPPED UP
  - AREAS OF EXISTING CARRIAGEWAY TO BE REMOVED
  - PROPOSED / IMPROVED PRIVATE MEANS OF ACCESS
  - PROPOSED / IMPROVED MAINTENANCE TRACK
  - EXISTING PRIVATE MEANS OF ACCESS TO BE STOPPED UP
  - EXISTING RIGHT OF WAY (BRIDLEWAY)
  - EXISTING RIGHT OF WAY (FOOTPATH)
  - EXISTING RIGHT OF WAY TO BE REMOVED
  - PROPOSED RIGHT OF WAY (BRIDLEWAY)
  - PROPOSED RIGHT OF WAY (FOOTPATH)
  - PROPOSED SHARED FOOTWAY / CYCLEWAY
  - PRIVATE MEANS OF ACCESS / RIGHT OF WAY TO BE IMPROVED, CREATED OR STOPPED UP DETAILED IN SCHEDULE 4
  - START / END POINT OF AREA OF EXISTING ROAD TO BE CREATED OR STOPPED UP DETAILED IN SCHEDULE 4
  - PROPOSED STRUCTURE

First Issue	MW	RR	06/12/19	P01
Updated following Consultee comments	MW	RR	16/01/20	P02
Revision Details	By	Check	Date	Suffix

**DCO APPLICATION**

Client  
Highways England  
Floor 5  
Two Colmore Square  
38 Colmore Circus  
Birmingham  
B4 6BN

Development Consent Order Number  
**TR010054**

Project Title  
**M54 to M6 Link Road**

Development Consent Order Drawing Number  
**TR010054/APP/2.7**

Drawing Title  
**STREETS, RIGHTS OF WAY AND ACCESS PLANS  
REGULATION 5(2)(K)  
SHEET 10 OF 10**

Designed MW	Drawn MW	Checked AM	Approved RR	Date 16/01/20
Internal Project No. 60536736	Suitability SB	Scale @ A1 1:2500H/1:2500V	Zone	Development Consent Order

THIS DOCUMENT HAS BEEN PREPARED PURSUANT TO AND SUBJECT TO THE TERMS OF AECOM'S APPOINTMENT BY ITS CLIENT. AECOM ACCEPTS NO LIABILITY FOR ANY USE OF THIS DOCUMENT OTHER THAN BY ITS ORIGINAL CLIENT OR FOLLOWING AECOM'S EXPRESS AGREEMENT TO SUCH USE, AND ONLY FOR THE PURPOSES FOR WHICH IT WAS PREPARED AND PROVIDED.

Drawing Number HE514465 -ACM	Originator -DCO-	Volume -DR-CH-1410	Rev P02
Location Z3_SW_PR_Z	Type I	Role I	Number I